

Courtesy Of Ke Wang Of MaxWell Polaris

# \$369,900 - 2203 10238 103 Street, Edmonton

MLS® #E4429438

**\$369,900**

2 Bedroom, 2.00 Bathroom, 755 sqft  
Condo / Townhouse on 0.00 Acres

Downtown (Edmonton), Edmonton, AB

GORGEOUS/UPGRADED condo located on the 22nd floor in Edmonton's prestigious tower the Ultima! This well laid out CORNER UNIT features high end finishing throughout, 2 large bedrooms, 2 full washrooms, TWO TITLED UNDERGROUND parking, spectacular views from every room, floor to ceiling windows, balcony, upgraded kitchen w/ quartz countertops, upgraded cabinets & appliances with soft close drawers! Ultima residence include access to a spectacular 10th floor amenities center w/ social room, fitness room, outdoor patio w/ a hot tub! Located in the heart of Edmonton downtown social scene, walking distance to Rogers Place, shops, cafes, restaurants & lounges!

Built in 2016

## Essential Information

MLS® #	E4429438
Price	\$369,900
Bedrooms	2
Bathrooms	2.00
Full Baths	2
Square Footage	755
Acres	0.00
Year Built	2016
Type	Condo / Townhouse

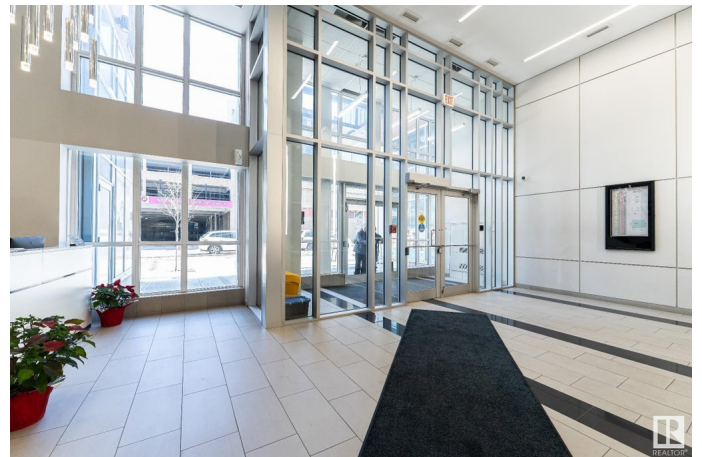

Sub-Type	Apartment High Rise
Style	Single Level Apartment
Status	Active

### **Community Information**

Address	2203 10238 103 Street
Area	Edmonton
Subdivision	Downtown (Edmonton)
City	Edmonton
County	ALBERTA
Province	AB
Postal Code	T5J 0G6

### **Amenities**

Amenities	Air Conditioner, Ceiling 9 ft., No Animal Home, No Smoking Home, Patio
Parking Spaces	2
Parking	Heated, Stall, Underground

### **Interior**

Interior Features	ensuite bathroom
Appliances	Air Conditioning-Central, Dishwasher-Built-In, Dryer, Microwave Hood Fan, Refrigerator, Stove-Electric, Washer
Heating	Forced Air-1, Natural Gas
# of Stories	33
Stories	1
Has Basement	Yes
Basement	None, No Basement

### **Exterior**

Exterior	Concrete, Metal, Stone
Exterior Features	Playground Nearby, Public Transportation, Schools, Shopping Nearby, View City, View Downtown
Roof	EPDM Membrane
Construction	Concrete, Metal, Stone
Foundation	Concrete Perimeter

### **School Information**

Elementary	Garneau School
Middle	McKernan School

High

Victoria School

### **Additional Information**

Date Listed April 6th, 2025

Days on Market 9

Zoning Zone 12

Condo Fee \$538

DATA IS DEEMED RELIABLE BUT IS NOT GUARANTEED ACCURATE BY THE REALTORS® ASSOCIATION OF EDMONTON. COPYRIGHT 2025 BY THE REALTORS® ASSOCIATION OF EDMONTON. ALL RIGHTS RESERVED. Trademarks are owned or controlled by the Canadian Real Estate Association (CREA) and identify real estate professionals who are members of CREA (REALTOR®, REALTORS®) and/or the quality of services they provide (MLS®, Multiple Listing Service®)

Listing information last updated on April 15th, 2025 at 6:32am MDT