

**\$699,900**

Hilddowns, Spruce Grove, AB

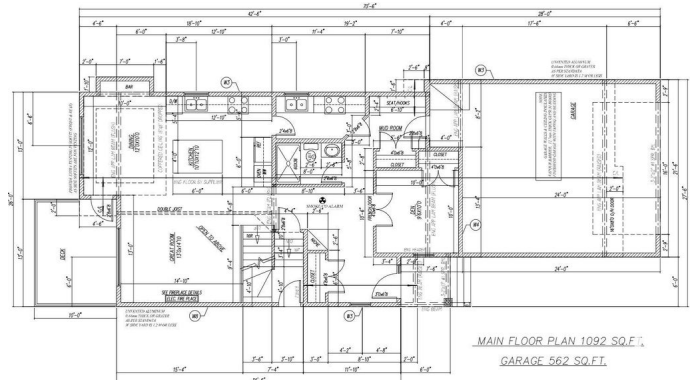

FRONT ELEVATION



## Essential Information

|        |           |
|--------|-----------|
| MLS® # | E4426147  |
| Price  | \$699,900 |

|                |                        |
|----------------|------------------------|
| Bedrooms       | 5                      |
| Bathrooms      | 3.00                   |
| Full Baths     | 3                      |
| Square Footage | 2,396                  |
| Acres          | 0.00                   |
| Year Built     | 2024                   |
| Type           | Single Family          |
| Sub-Type       | Detached Single Family |
| Style          | 2 Storey               |
| Status         | Active                 |

### Community Information

|             |              |
|-------------|--------------|
| Address     | 13 Hull Wynd |
| Area        | Spruce Grove |
| Subdivision | Hilldowns    |
| City        | Spruce Grove |
| County      | ALBERTA      |
| Province    | AB           |
| Postal Code | T7X 0X5      |

### Amenities

|                |  |
|----------------|--|
| Amenities      | On Street Parking, Ceiling 10 ft., Ceiling 9 ft., Deck, Parking-Extra, Parking-Visitor |
| Parking Spaces | 4  |
| Parking        | Double Garage Attached, Front Drive Access   |

### Interior

|                   |   |
|-------------------|---|
| Interior Features | ensuite bathroom                        |
| Appliances        | Garage Control, Garage Opener, Hood Fan |
| Heating           | Forced Air-1, Natural Gas               |
| Stories           | 2                                       |
| Has Basement      | Yes                                     |
| Basement          | Full, Unfinished                        |

### Exterior

|                   |   |
|-------------------|---|
| Exterior          | Wood, Vinyl   |
| Exterior Features | Airport Nearby, Golf Nearby, Picnic Area, Playground Nearby, Private Setting, Public Transportation, Schools, Shopping Nearby |
| Roof              | Asphalt Shingles  |

|              |                    |
|--------------|--------------------|
| Construction | Wood, Vinyl        |
| Foundation   | Concrete Perimeter |

**Additional Information**

|                |                  |
|----------------|------------------|
| Date Listed    | March 17th, 2025 |
| Days on Market | 36               |
| Zoning         | Zone 91          |

DATA IS DEEMED RELIABLE BUT IS NOT GUARANTEED ACCURATE BY THE REALTORS® ASSOCIATION OF EDMONTON. COPYRIGHT 2025 BY THE REALTORS® ASSOCIATION OF EDMONTON. ALL RIGHTS RESERVED.Trademarks are owned or controlled by the Canadian Real Estate Association (CREA) and identify real estate professionals who are members of CREA (REALTOR®, REALTORS®) and/or the quality of services they provide (MLS®, Multiple Listing Service®)

Listing information last updated on April 22nd, 2025 at 1:47am MDT